



Compressor Selection: Compact Screw Compressors CS

Input Values

Compressor model	(CSH6561-60Y)	Operating mode	Standard
Refrigerant	R407C	Power supply	400V-3-50Hz
Reference temperature	Dew point temp.	Capacity Control	100%
Liq. subc. (in condenser)	0 K	Additional cooling	Automatic
Suct. gas superheat	10,00 K	Max. discharge gas temp.	110,0 °C
Useful superheat	100%		

Result

Q [W]	Cooling capacity	mHP [kg/h]	Mass flow HP
P [kW]	Power input	Qac [kW]	Additional cooling
I [A]	Current	tcu [°C]	Liquid temp.
COP [-]	COP/EER	pm [bar(a)]	ECO pressure
mLP [kg/h]	Mass flow LP	Qsc [kW]	sub cooler capacity (ECO)

tc	to	10°C	5°C	0°C	-5°C	-10°C	-15°C	-20°C	-25°C
30°C	Q [W]	206158	172450	143177	117826	95926	77042	--	--
	P [kW]	32,4	30,8	29,4	28,2	27,2	26,4		
	I [A]	58,6	56,4	54,7	53,2	52,0	50,9		
	COP [-]	6,36	5,60	4,87	4,17	3,52	2,92		
	mLP [kg/h]	3962	3360	2830	2364	1954	1595		
	mHP [kg/h]	3962	3360	2830	2364	1954	1595		
	Qac [kW]	--	--	--	--	--	--		
	tcu [°C]	24,6	24,6	24,6	24,6	24,6	24,6		
	pm [bar(a)]	--	--	--	--	--	--		
	Qsc [kW]	--	--	--	--	--	--		
40°C	Q [W]	184485	153620	126825	103620	83567	66253	--	--
	P [kW]	39,3	37,2	35,6	34,5	33,6	32,7		
	I [A]	67,9	65,0	62,9	61,4	60,1	59,0		
	COP [-]	4,69	4,13	3,56	3,00	2,49	2,03		
	mLP [kg/h]	3879	3279	2749	2283	1873	1512		
	mHP [kg/h]	3879	3279	2749	2283	1873	1512		
	Qac [kW]	--	--	--	--	--	--		
	tcu [°C]	34,9	34,9	34,9	34,9	34,9	34,9		
	pm [bar(a)]	--	--	--	--	--	--		
	Qsc [kW]	--	--	--	--	--	--		
50°C	Q [W]	159320	132004	108178	87394	69231	53281	--	--
	P [kW]	47,0	45,4	44,1	42,9	41,8	40,8		
	I [A]	78,7	76,4	74,5	72,9	71,4	70,0		
	COP [-]	3,39	2,91	2,46	2,04	1,66	1,31		
	mLP [kg/h]	3719	3133	2612	2149	1735	1362		
	mHP [kg/h]	3719	3133	2612	2149	1735	1362		
	Qac [kW]	--	--	--	--	--	3,49		
	tcu [°C]	45,4	45,4	45,4	45,4	45,4	45,4		
	pm [bar(a)]	--	--	--	--	--	--		
	Qsc [kW]	--	--	--	--	--	--		

-- No calculation possible (see message in single point selection)

*According to EN12900 (10K suction gas superheat, 0K liquid subcooling, see T.Data/ Notes)

Application Limits Standard

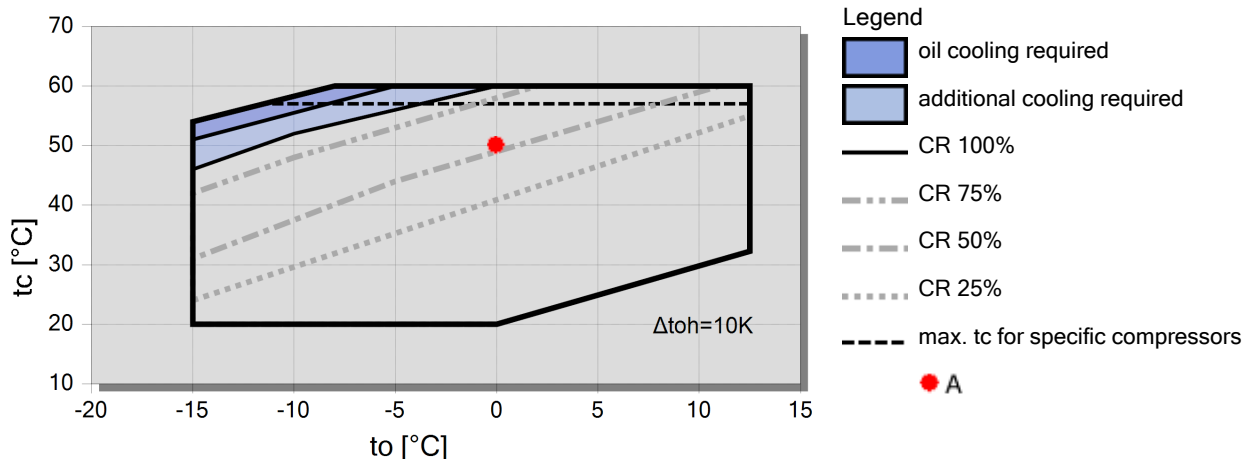



Technical Data: (CSH6561-60Y)

Dimensions and Connections

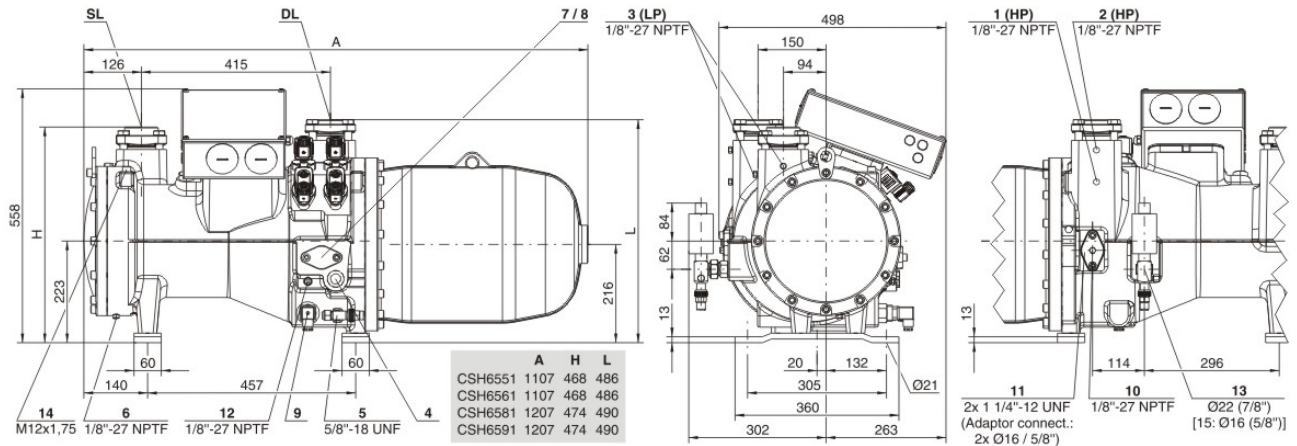

Technical Data

Technical Data

Displacement (2900 RPM 50 Hz)	170 m3/h
Displacement (3500 RPM 60 Hz)	205 m3/h
Weight	322 kg
Max. pressure (LP/HP)	19 / 28 bar
Connection suction line	54 mm - 2 1/8"
Connection discharge line	42 mm - 1 5/8"
Oil type R22	B320SH (Standard)
Oil type R134a/R407C/R404A/R507A/R407A/R407F	BSE170 (Option)

Motor data

Motor voltage (more on request)	380-415V PW-3-50Hz
Max operating current	108.0 A
Winding ratio	50/50
Starting current (Rotor locked)	269.0 A D / 508.0 A DD
Max. Power input	65,0 kW

Extent of delivery (Standard)

Enclosure class	IP54
Oil heater	200 W (Standard)
Oil separator	Standard
Oil filter	Standard
Discharge gas temperature sensor	Standard
Start unloading	Standard
Capacity Control - 4-step	100-75-50-25% (Standard)
Capacity Control - infinite	100-25% (Standard)
Built-in check valve	Standard
Motor protection	SE-E1 (Standard), INT69VSY-II(Standard for 660-690V)
Oil charge	9,5 dm3

Available Options

Oil level switch	Option
Discharge shut-off valve	Option
Suction shut-off valve	Option
Shut-off valve for ECO with muffler	Option
Liquid injection with integrated nozzle	Option
Bridges for DOL start	Option
Vibration dampers	Option