



BITZER Output data

Created on : 08.03.2021 11:47:05



## Selection: Semi-hermetic Reciprocating Compressors

### Input Values

Compressor model	(4EC-6.2Y)	Suction gas temperature	20,00 °C
Mode	Refrigeration and Air conditioning	Operating mode	Auto
Refrigerant	R404A	Power supply	400V-3-50Hz
Reference temperature	Dew point temp.	Capacity control	100%
Liq. subc. (in condenser)	0 K	Useful superheat	100%

### Result

Q [W]	Cooling capacity	COP [ - ]	COP/EER
Qu* [W]	Evaporator capacity	m [kg/h]	Mass flow
P [kW]	Power input	Op.	Operating mode
I [A]	Current	th [°C]	Discharge gas temp. w/o cooling
Qc [W]	Condenser capacity		

tc	to	5°C	0°C	-5°C	-10°C	-15°C	-20°C	-25°C	-30°C
30°C	Q [W]	25213	21127	17578	14497	11829	9526	7548	5858
	Qu* [W]	25213	21127	17578	14497	11829	9526	7548	5858
	P [kW]	4,75	4,73	4,62	4,43	4,17	3,85	3,48	3,08
	I [A]	8,56	8,52	8,37	8,11	7,76	7,35	6,91	6,44
	Qc [W]	29967	25857	22196	18924	15996	13376	11033	8941
	COP [ - ]	5,30	4,47	3,81	3,27	2,84	2,47	2,17	1,90
	m [kg/h]	650	537	442	361	292	233	183,8	141,9
	Op.	Standard	Standard	Standard	Standard	Standard	Standard	Standard	Standard
	th [°C]	56,6	63,2	70,1	77,4	85,2	93,4	102,4	112,2
40°C	Q [W]	21241	17775	14752	12120	9835	7859	6159	4704
	Qu* [W]	21241	17775	14752	12120	9835	7859	6159	4704
	P [kW]	5,81	5,62	5,35	5,01	4,61	4,17	3,68	3,17
	I [A]	10,06	9,78	9,39	8,91	8,36	7,76	7,15	6,54
	Qc [W]	27049	23392	20099	17128	14446	12025	9842	7878
	COP [ - ]	3,66	3,16	2,76	2,42	2,13	1,89	1,67	1,48
	m [kg/h]	619	510	418	339	273	216	168,3	127,9
	Op.	Standard	Standard	Standard	Standard	Standard	Standard	Standard	Standard
	th [°C]	68,4	75,1	82,2	89,6	97,5	106,0	115,2	125,3
50°C	Q [W]	17355	14492	11984	9793	7888	6238	4818	3604
	Qu* [W]	17355	14492	11984	9793	7888	6238	4818	3604
	P [kW]	6,72	6,37	5,95	5,47	4,95	4,38	3,79	3,19
	I [A]	11,41	10,89	10,27	9,57	8,83	8,05	7,28	6,56
	Qc [W]	24074	20861	17934	15266	12834	10621	8611	6791
	COP [ - ]	2,58	2,28	2,01	1,79	1,59	1,42	1,27	1,13
	m [kg/h]	589	483	393	317	253	198,0	151,7	112,8
	Op.	Standard	Standard	Standard	Standard	Standard	Standard	Standard	Standard
	th [°C]	80,3	87,1	94,3	102,0	110,1	118,9	128,6	139,4

-- No calculation possible (see message in single point selection)

\*According to EN12900 (20°C suction gas temp., 0K liquid subcooling)

## Application Limits 100% Octagon 4EC-6.2



## Technical Data: (4EC-6.2Y)

### Dimensions and Connections

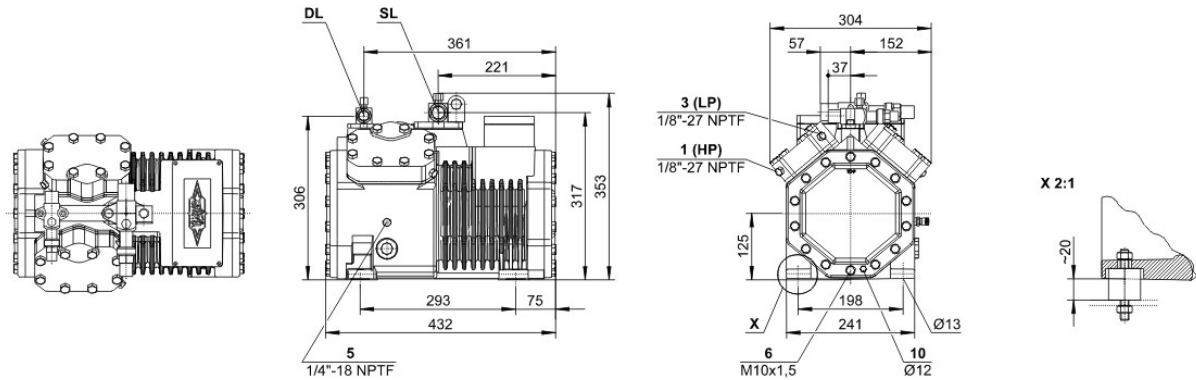

### Technical Data

#### Technical Data

Displacement (1450 RPM 50Hz)	22,72 m3/h
Displacement (1750 RPM 60Hz)	27,42 m3/h
No. of cylinder x bore x stroke	4 x 46 mm x 39,3 mm
Weight	86 kg
Max. pressure (LP/HP)	19 / 28 bar
Connection suction line	28 mm - 1 1/8"
Connection discharge line	16 mm - 5/8"
Oil type R134a/R407C/R404A/R507A/R407A/R407F	tc<55°C: BSE32   tc>55°C: BSE55 (Option)
Oil type R22 (R12/R502)	B5.2 (Standard)
Oil type R290/R1270	SHC226E (Standard)

#### Motor data

Motor voltage (more on request)	380-420V Y-3-50Hz
Max operating current	13.2 A
Starting current (Rotor locked)	62.2 A
Max. Power input	7,9 kW

#### Extent of delivery (Standard)

Motor protection	SE-B1
Enclosure class	IP65
Vibration dampers	Standard
Oil charge	2,00 dm <sup>3</sup>

#### Available Options

Discharge gas temperature sensor	Option
Start unloading	Option
Capacity control	100-50% (Option)
Additional fan	Option
Crankcase heater	0..120 W PTC (Option)
Oil level monitoring	OLC-K1 (Option, not for R290/R1270)

#### Sound measurement

Sound power level (+5°C / 50°C)	68,5 dB(A) @ 50Hz
Sound power level (-10°C / 45°C)	70,0 dB(A) @ 50Hz
Sound power level (-35°C / 40°C)	(72,0) dB(A) @ 50Hz
Sound pressure level @ 1m (+5°C / 50°C)	60,5 dB(A) @ 50Hz
Sound pressure level @ 1m (-10°C / 45°C)	62,0 dB(A) @ 50Hz
Sound pressure level @ 1m (-35°C / 40°C)	(64,0) dB(A) @ 50Hz