



### 1 FH Series

Centrifugal electric pumps according to EN 733 (ex DIN 24255). Electric pumps with pump casing in cast iron and impeller in AISI 316\* stainless steel, designed to pump hot, cold and moderately aggressive liquids.

Available versions:

**FHE** Close-coupled with special motor shaft extension.

**FHS** With stub shaft and standard motor.

**FHF** With adapter, support, flexible coupling, base and standard motor according to EN 733 (ex DIN 24255).

#### SPECIFICATIONS

**Delivery:** up to 700 m<sup>3</sup>/h

**Head:** up to 100 m

**Power supply:** three-phase and single-phase 50 and 60 Hz

**Power:** 0.25 kW to 132 kW

**Maximum operating pressure:**

12 bar PN12 up to FH80

flanges PN16 for FH100,125,150

**Temperature of pumped liquid:**

-20°C to +85°C (FH32 to 80)

-30°C to +120°C (FH100 to 150)

**Insulation class:** F

**Protection:** IP55

#### MATERIALS

**Pump body:** Cast iron

**Impeller:** Stainless steel for sizes 32, 40, 50 and 65-125

Cast iron for remaining sizes

**Adapter:** Aluminium or Cast iron

**Mechanical seal:** Ceramic/Carbon/NBR

**Elastomers:** NBR

#### APPLICATIONS

- Water distribution
- Heating, ventilation
- Pressure boosting, irrigation
- Industrial washing equipment, swimming pools
- Cooling and chilling
- General industry, water treatment
- Heat recovery, filtration equipment
- Auxiliary equipment, fire-fighting equipment

Available on request:

- version with Hydrovar frequency converter
- version with efficiency level 1 motor on FHS and FHF
- version with 4-pole motor
- version with bronze impeller



\* Check material table for availability

For a complete list of technical information, consult [www.lowara.com](http://www.lowara.com)



### FHE4 SERIES - DIMENSIONS AND WEIGHTS, 4 POLES

1

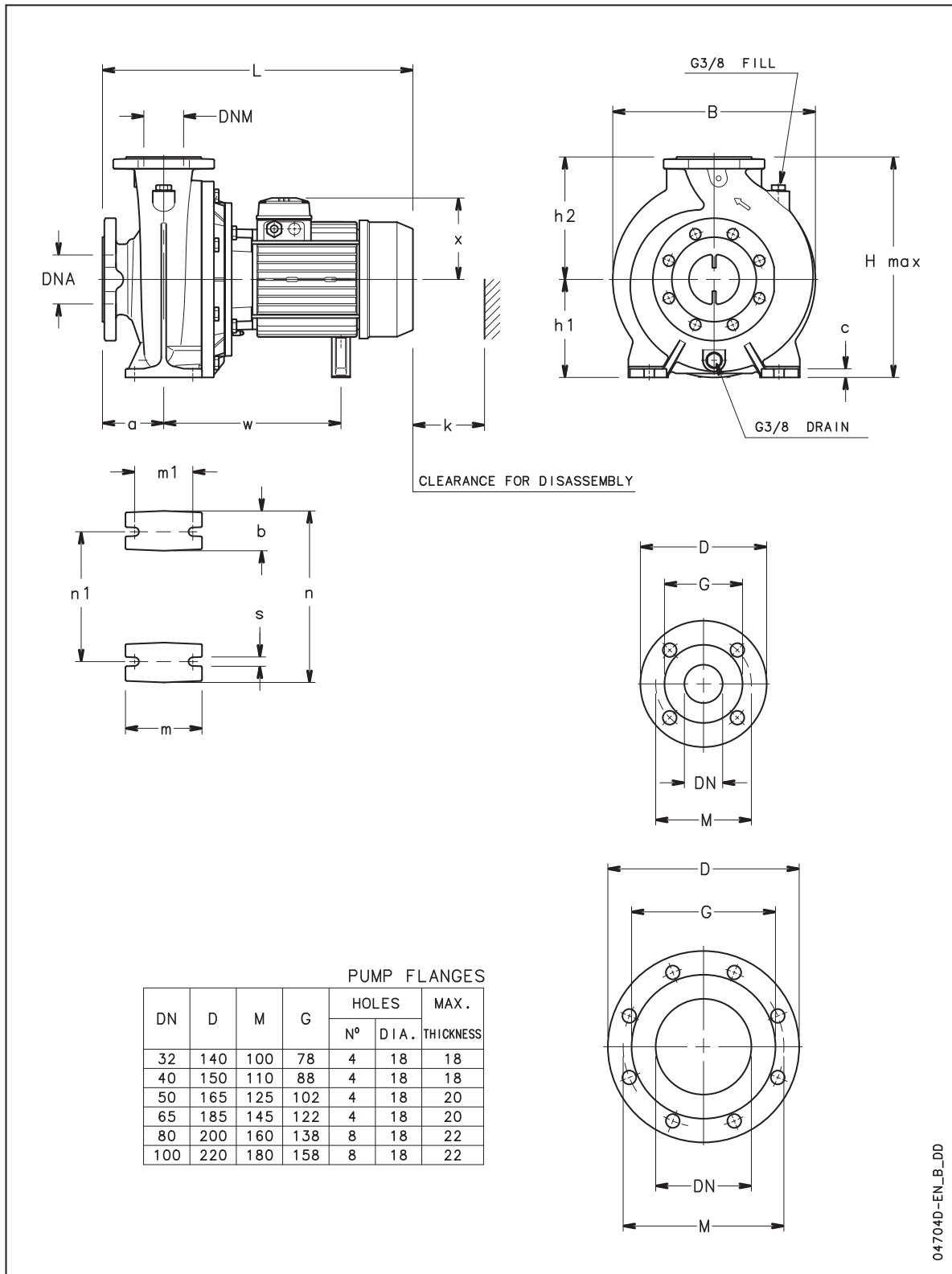

04704D-EN\_B\_DD



## General Catalogue

### FHE4 SERIES - DIMENSIONS AND WEIGHTS, 4 POLES

PUMP TYPE	DIMENSIONS (mm)															B	H max	L	k	WEIGHT kg
	PUMP				STAND															
	DNM	DNA	a	h2	w	x	b	c	h1	m	m1	n	n1	s						
FHE4 32-125/02A	32	50	80	140	215	121	50	12	112	100	70	190	140	14	233	252	411	86	25	
FHE4 32-125/02	32	50	80	140	215	121	50	12	112	100	70	190	140	14	233	252	411	86	25	
FHE4 32-160/02	32	50	80	160	215	121	50	12	132	100	70	240	190	14	235	292	411	86	26	
FHE4 32-160/03	32	50	80	160	215	121	50	12	132	100	70	240	190	14	235	292	411	86	26	
FHE4 32-200/03	32	50	80	180	215	121	50	12	160	100	70	240	190	14	285	340	411	86	35	
FHE4 32-200/05	32	50	80	180	235	129	50	12	160	100	70	240	190	14	285	340	443	86	38	
FHE4 40-125/02A	40	65	80	140	215	121	50	12	112	100	70	210	160	14	233	252	411	88	25	
FHE4 40-125/02	40	65	80	140	215	121	50	12	112	100	70	210	160	14	233	252	411	88	25	
FHE4 40-125/03	40	65	80	140	215	121	50	12	112	100	70	210	160	14	233	252	411	88	25	
FHE4 40-160/03	40	65	80	160	215	121	50	12	132	100	70	240	190	14	250	292	411	88	27	
FHE4 40-160/05	40	65	80	160	235	129	50	12	132	100	70	240	190	14	250	292	443	88	29	
FHE4 40-200/07	40	65	100	180	235	129	50	12	160	100	70	265	212	14	285	340	463	88	39	
FHE4 40-200/11	40	65	100	180	245	134	50	12	160	100	70	265	212	14	285	340	498	88	48	
FHE4 40-250/11	40	65	100	225	245	134	65	14	180	125	95	320	250	14	335	405	498	107	58	
FHE4 40-250/15	40	65	100	225	245	134	65	14	180	125	95	320	250	14	335	405	498	107	61	
FHE4 40-250/22	40	65	100	225	285	168	65	14	180	125	95	320	250	14	335	405	522	107	69	
FHE4 50-125/03A	50	65	100	160	217	121	50	12	132	100	70	240	190	14	255	292	433	92	29	
FHE4 50-125/03	50	65	100	160	217	121	50	12	132	100	70	240	190	14	255	292	433	92	29	
FHE4 50-125/05	50	65	100	160	237	129	50	12	132	100	70	240	190	14	255	292	465	92	32	
FHE4 50-160/07	50	65	100	180	237	129	50	12	160	100	70	265	212	14	285	340	465	92	42	
FHE4 50-160/11	50	65	100	180	247	134	50	12	160	100	70	265	212	14	285	340	500	92	51	
FHE4 50-200/11	50	65	100	200	247	134	50	12	160	100	70	265	212	14	305	360	500	92	51	
FHE4 50-200/15	50	65	100	200	247	134	50	12	160	100	70	265	212	14	305	360	500	92	54	
FHE4 50-250/22A	50	65	100	225	285	168	65	14	180	125	95	320	250	14	340	405	522	107	69	
FHE4 50-250/22	50	65	100	225	285	168	65	14	180	125	95	320	250	14	340	405	522	107	69	
FHE4 50-250/30	50	65	100	225	285	168	65	14	180	125	95	320	250	14	340	405	553	107	72	
FHE4 65-125/05	65	80	100	180	237	129	65	14	160	125	95	280	212	14	285	340	465	105	46	
FHE4 65-125/07	65	80	100	180	237	129	65	14	160	125	95	280	212	14	285	340	465	105	46	
FHE4 65-125/11	65	80	100	180	247	134	65	14	160	125	95	280	212	14	285	340	500	105	55	
FHE4 65-160/11	65	80	100	200	245	134	65	14	160	125	95	280	212	14	331	360	498	112	61	
FHE4 65-160/15	65	80	100	200	245	134	65	14	160	125	95	280	212	14	331	360	498	112	65	
FHE4 65-160/22	65	80	100	200	285	168	65	14	160	125	95	280	212	14	331	360	522	112	73	
FHE4 65-200/15	65	80	100	225	245	134	65	14	180	125	95	320	250	14	335	405	498	112	65	
FHE4 65-200/22	65	80	100	225	285	168	65	14	180	125	95	320	250	14	335	405	522	112	73	
FHE4 65-200/30	65	80	100	225	285	168	65	14	180	125	95	320	250	14	335	405	553	112	75	
FHE4 65-250/30	65	80	100	250	285	168	80	16	200	160	120	360	280	18	360	450	553	112	84	
FHE4 65-250/40	65	80	100	250	315	168	80	16	200	160	120	360	280	18	360	450	598	112	125	
FHE4 65-250/55	65	80	100	250	343	191	80	16	200	160	120	360	280	18	360	450	605	112	130	
FHE4 80-160/15	80	100	125	225	245	134	65	14	180	125	95	320	250	14	332	405	523	129	70	
FHE4 80-160/22	80	100	125	225	285	168	65	14	180	125	95	320	250	14	332	405	547	129	78	
FHE4 80-200/30	80	100	125	250	285	168	65	14	180	125	95	345	280	14	345	430	578	129	89	
FHE4 80-200/40	80	100	125	250	315	168	65	14	180	125	95	345	280	14	345	430	623	129	123	
FHE4 80-250/40	80	100	125	280	315	168	80	16	200	160	120	400	315	18	400	480	623	129	120	
FHE4 80-250/55	80	100	125	280	343	191	80	16	200	160	120	400	315	18	400	480	630	129	125	
FHE4 80-250/75	80	100	125	280	343	191	80	16	200	160	120	400	315	18	400	480	630	129	129	

fh-fhe4-4p50-en\_c\_td

